

Since 1940

# LARZEP











HYDRAULIC

## AUTOMOTIVE. GENERAL FEATURES

- Wide range of jacks and automotive products including: Bottle jacks, High lift transmission jacks, Trolley jacks, Portable cranes, Hydraulic tables, Air service jacks, High tonnage air service jacks, Pipe benders, Presses, Maintenance units and Lightweight rescue unit.
- Bottle jacks from 2 to 50 Tn. Also available telescopic jacks and with pressure gauge.
- High lift hydraulic transmission jacks have 4 wheels for easy manoeuvrability. The adaptable head allows a variety of jobs to be undertaken safely.
- Trolley jacks are save and have a precise control during lifting or lowering operations.
- Portable hydraulic cranes with an extendable jib to increase reach and with heavy duty wheels and swivel rear castor for easy movement.
- Single lift or double lift hydraulic tables available as standard. The tables can be blocked at different heights with safety pins.
- Three telescopic air service jacks available as standard. Easy to operate, with the control located on the end of the handle and with three-position handle to place the jack under the load SAFELY.
- High tonnage air service jacks from 30 to 150 Tn with one, two or three stages. Easy to operate, with the control located on the end of the handle and with three-position handle to place the jack under the load SAFELY.
- Hydraulic pipe benders suitable for carrying out operations with plumbing pipes from 3/8" to 6". Available with electric, air hydraulic or hand pump.
- Presses from 10 to 250 Tn with strong bench mount frame (EC models 10 and 20 Tn) or floor mounted H frame. Available with electric, air hydraulic or hand pump.
- Maintenance unit designed for operations such as pushing, separating, joining, lifting, compressing, stretching and fixing.
- Lightweight rescue unit do not need for external power. It is used for separating, cutting and pushing, the three basic operations in a rescue.



# Automotive

Models	Capacity Tn	Tool type		Page
A - AB - AC	2-50	Hydraulic Bottle Jacks		148
AF	0.25-1.5	High Lift Hydraulic Transmission Jacks		150
B	2-20	Trolley Jacks		151
DLG	0.5-2	Portable Hydraulic Cranes		152
F	0.5-1.5	Hydraulic Tables		153
HN	30-80	Air Service Jacks		154
HL	60-150	High Tonnage Air Service Jacks		156
VA - VB - VC - VZ	3/8-6 inch	Hydraulic Pipe Benders		158
EC - EE - EM - EZ	10-250	Hydraulic Presses		160
CA	5-20	Maintenance Sets		164
CS	0.7-7	Lightweight Rescue Unit		168



**HYDRAULIC BOTTLE JACKS****LARZEP advantages**

- From 2 to 50 Tn.
- Up to 30Tn 'A' Models are single stage with screw extension.
- 20Tn and 30Tn 'AC' versions are supplied with pressure gauge, calibrated to read in tonnes with  $\pm 1,6\%$  accuracy.
- 'AB' versions are telescopic with two hydraulic extensions.
- All models with safety relief valve.
- Forged material base.
- Supplied with zinc plated handle and individual cardboard box.
- Bottle jacks will operate horizontally, provided that the pump element is at the lowest point.

Carefully read and understand the safety instructions.





Bottle jack with lock nut



50 Tn, 2 speed,  
long stroke bottle jack

## HYDRAULIC BOTTLE JACKS

# A-AB-AC

2-50 Tn.

700 bar

AUTOMOTIVE

Larzep designs and manufactures special jacks, upon request.



### BOTTLE JACKS - A

Capacity	Model	A	B	C	D	Screw E	Weight
Tn	LARZEP	mm	mm	mm	mm	mm	kg
2	A40211	172	372	112	103x105	88	3,9
3	A40311	172	372	112	103x105	88	3,9
5	A40515	212	468	146	110x112	110	5,0
8	A40815	220	483	148	124x127	115	7,5
10	A41015	220	483	148	124x127	115	7,5
15	A41515	231	498	154	140x142	113	10,1
20	A22014	214	421	142	160x168	65	8,5
30	A23014	222	429	142	154x164	65	11,0
50	A25014	216	361	145	180x190	-	19,9

### A-AC

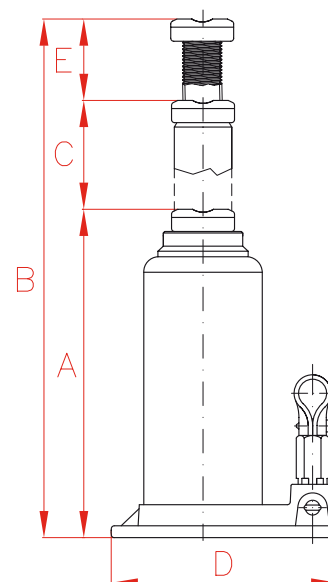

### AB

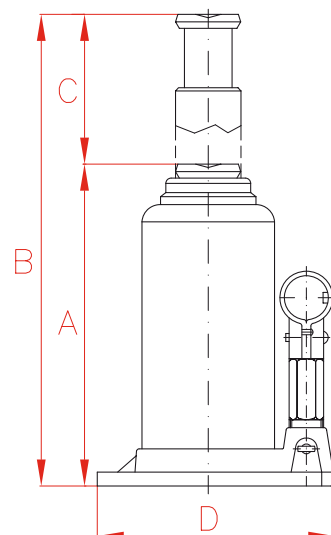

### BOTTLE JACKS WITH PRESSURE GAUGE - AC

Capacity	Model	A	B	C	D	Screw E	Weight
Tn	LARZEP	mm	mm	mm	mm	mm	kg
20	AC22014	214	421	142	160x168	65	8,7
30	AC23014	222	429	142	154x164	65	11,2

### TELESCOPIC BOTTLE JACKS - AB

Capacity	Model	A	B	C	D	Weight
Tn	LARZEP	mm	mm	mm	mm	kg
4	AB40434	265	610	345	124 x 128	7,5
10	AB21027	249	519	270	154 x 164	13,0

**HIGH LIFT HYDRAULIC TRANSMISSION JACKS**



**LARZEP advantages**

- From 250 to 1.500 kg lifting capacity.
- Hand operated release valve. Dead Man.
- Chrome plated piston.
- 4 castor wheels for easy manoeuvrability.
- Foot operated pump keeps hands free.
- Load saddle swivels to enable all direction operation.
- Packed in strong cardboard box.
- An adaptable head allows a variety of jobs to be undertaken safely.

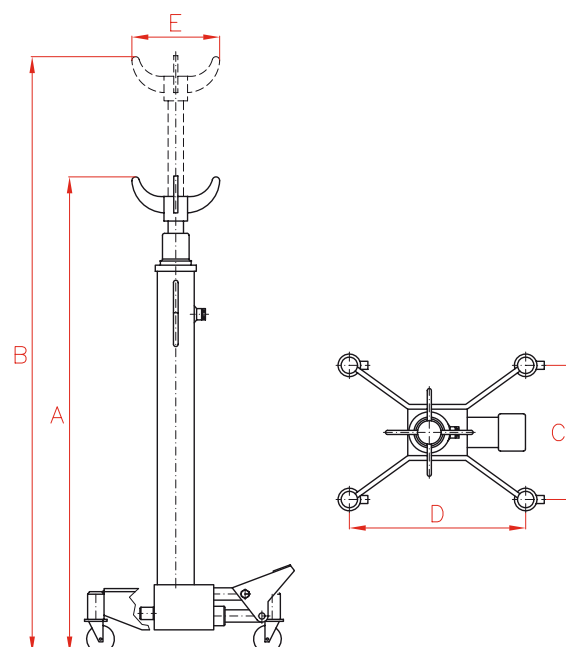

Capacity	Model	A	B	C	D	E	Weight
kg	LARZEP	mm	mm	mm	mm	mm	kg
250	AF25082	1.100	1.910	440	480	315	24
500	AF50080	1.130	1.930	410	510	320	35
1.000	AF100080	1.150	1.930	530	530	370	42
1.500	AF150080	1.150	1.930	550	610	380	60

TROLLEY JACKS

**B**

2-20 Tn.

700 bar

AUTOMOTIVE

## TROLLEY JACKS



### LARZEP advantages

- From 2 to 20 Tn.
- Two wide wheels to support the load and castor wheels for easier manoeuvrability.
- Handle features integral safety release mechanism to prevent accidental release.
- Rugged frame construction for heavy-duty operation.
- Safe and precise control during lifting or lowering operations.
- Foot pedal to provide quick approach.
- Safety valve avoids overpressure.
- End of stroke limiting valve.

Capacity	Stroke	Model	A	B	C	D	E	F	Weight
Tn	mm	LARZEP	mm	mm	mm	mm	mm	mm	kg
2	470	<b>B02047</b>	110	580	1.250	160	275	865	45
3	440	<b>B03044</b>	120	560	1.270	185	280	865	53
7	440	<b>B07044</b>	160	600	1.600	220	300	960	90
10	440	<b>B10044</b>	160	600	1.740	265	330	962	120
15	420	<b>B15042</b>	180	600	1.910	275	335	960	150
20	420	<b>B20042</b>	180	600	1.910	290	340	961	165

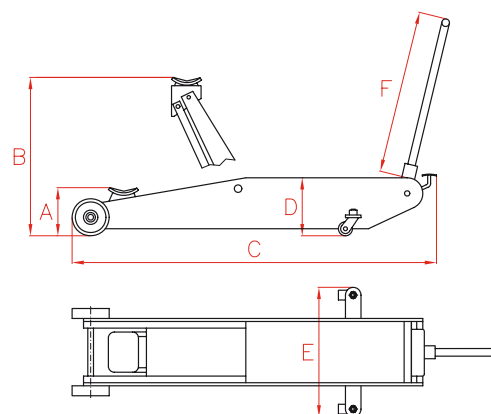

**PORTABLE HYDRAULIC CRANES**



Model	4 / 3 / 2 / 1 Jib position
LARZEP	kg
DLG005	500 - 400 - 350 - 250
DLG010	1.000 - 800 - 600 - 300
DLG020	2.000 - 1.800 - 1.700 - 1.600

**LARZEP advantages**

- From 500 to 2.000 kg lifting capacity.
- Heavy duty wheels and swivel rear castor for easy movement.
- Exceptionally versatile due to their compact dimensions when folded up.
- Fitted with a safety relief valve to prevent overloading.
- All models are fitted with an extendable jib to increase reach.
- Special lowering valve in all models for safer and better control of descent. If the knob is released accidentally, the arm stops.

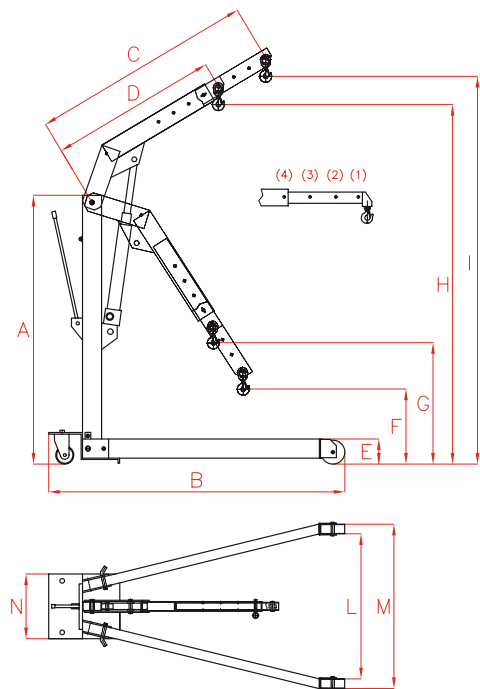

Capacity	Model	A	B	C	D	E	F	G	H	I	L	M	N	Weight
kg	LARZEP	mm	mm	mm	mm	mm	mm	mm	mm	mm	mm	mm	mm	kg
500	DLG005	1.540	1.530	1.320	1.010	143	100	400	2.040	2.190	730	860	430	83
1.000	DLG010	1.560	1.600	1.300	1.000	170	110	400	2.240	2.420	880	1.000	540	99
2.000	DLG020	1.700	2.000	1.540	1.240	200	0	300	2.520	2.770	1.055	1.220	620	175

## HYDRAULIC TABLES

# F

## 500-1.500 kg.

## 700 bar

AUTOMOTIVE

## HYDRAULIC TABLES



### LARZEP advantages

- Model F01571, single lift 1.500 kg capacity and 915 mm high.
- Model F005121, double lift 500 kg capacity and 1.600 mm high.
- A foot pedal is fitted to advance the lifting table quickly to contact the load. The operating handle is then used to lift the load.
- Special lowering valve means that the process is safe and controlled. Overload safety relief valve.
- The frame is in accordance with lifting table security standards.
- "T" operating handle facilitates easier operation.
- The table can be locked at different heights with safety pins.
- Strong steel platform, 1m x 0,5m.
- Heavy duty swivel castors.

**F01571**

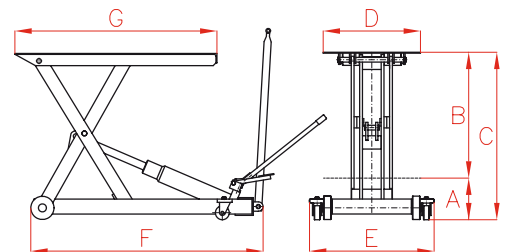

**F005121**

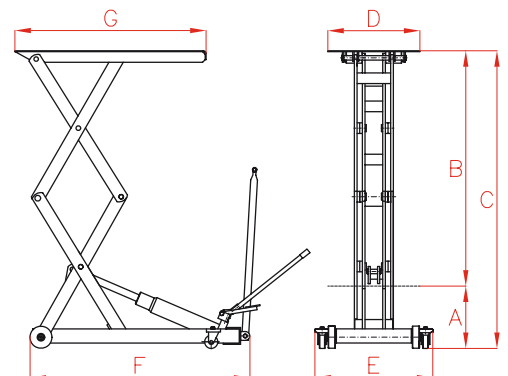

Capacity	Model	A	B	C	D	E	F	G	Weight
kg	LARZEP	mm	mm	mm	mm	mm	mm	mm	kg
500	F005121	270	1.285	1.555	520	666	1.242	1.080	182
1.500	F01571	235	675	910	520	666	1.242	1.080	141



**AIR SERVICE JACK****LARZEP advantages**

- From 30 to 80 Tn.
- Telescopic models with two and three stages.
- Operated by an air/hydraulic pump. Air pressure required: 8 to 12 bar.
- Ram return is automatic. Constant and controlled speed under load, can be increased without load.
- Check valves guarantee load holding, even if an air or oil pipe is accidentally broken.
- Equipped with an overpressure safety valve as protection against overloading.
- Three-position handle can be lowered to place the jack under the load.
- A hardened serrated load saddle and extension pieces of 70 and 120 mm are supplied as standard.
- Easy to operate, with the control located on the end of handle.



## AIR SERVICE JACKS

# HN

### 30-80 Tn.

### 8-12 bar

AUTOMOTIVE

### HN231

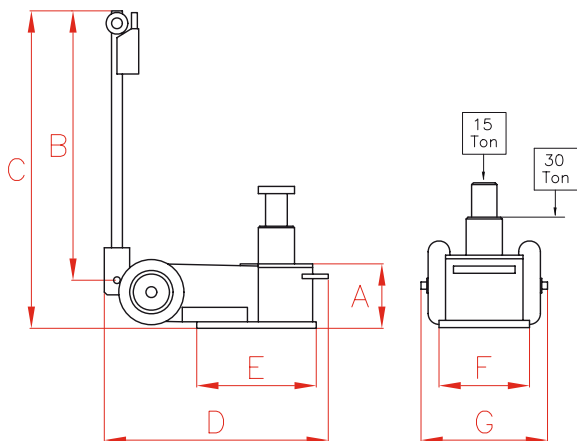

### HN360

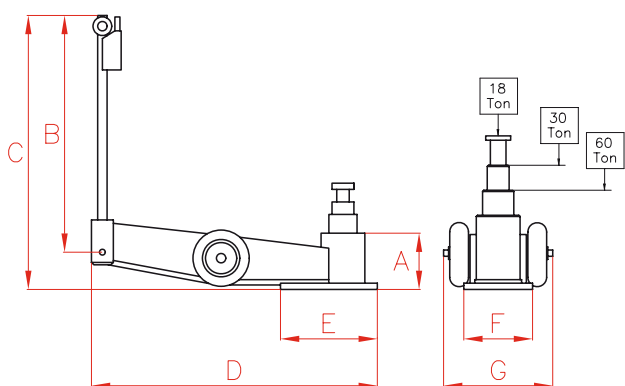

Extension pieces of 70 and 120 mm are supplied as standard.

### HN480

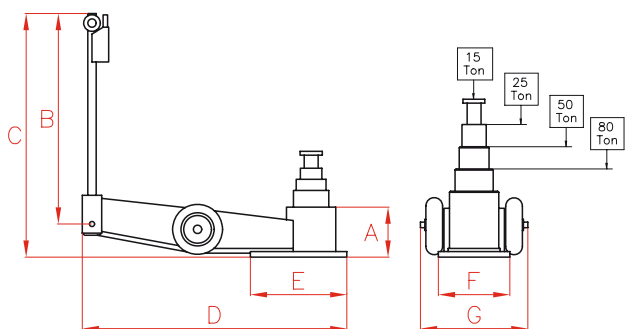

High Tonnage Air Service Jacks, HL.

Page. 156

Capacity	Stroke	Model	A	B	C	D	E	F	G	Weight
Tn	mm	LARZEP	mm	mm	mm	mm	mm	mm	mm	kg
15/30	88+83	HN231	150	1.315	1.400	525	270	206	300	39
18/30/60	91+72+74	HN360	180	1.310	1.395	980	320	240	350	70
15/25/50/80	66+56+68+60	HN480	180	1.310	1.395	980	320	240	350	78

**HIGH TONNAGE AIR SERVICE JACK**



**LARZEP advantages**

- From 60 to 150 Tn.
- Models with one stage and telescopic with two and three stages.
- Operated by an air/hydraulic pump. Air pressure required: 8 to 12 bar.
- Air inlet port: 1/2" BSP.
- Dual descent valve for greater control.
- Fitted with self sealing pneumatic tyres for easy manoeuvrability.
- Special hooks for transport.
- Ram return is automatic. Constant and controlled speed under load, can be increased without load.
- Check valves guarantee load holding, even if an air or oil pipe is accidentally broken.
- Equipped with an overpressure safety valve as protection against overloading.
- Three-position handle can be lowered to place the jack under the load.
- Easy to operate, with the control located on the end of handle.
- Wide range of optional accessories: remote pendant, manual emergency pump, safety load blocks, safety block holder, safety blocks kit, extensions and extension holder.



Safety block



Holder

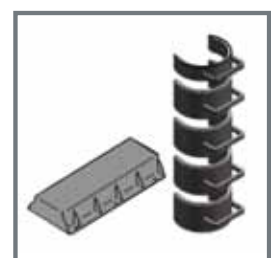

Kit

## HIGH TONNAGE AIR JACKS

# HL

## 60-150 Tn.

## 8-12 bar

AUTOMOTIVE

### HL08042

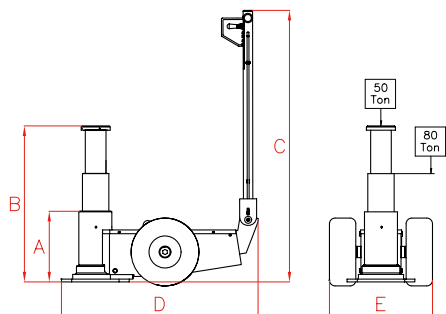

### HL08052

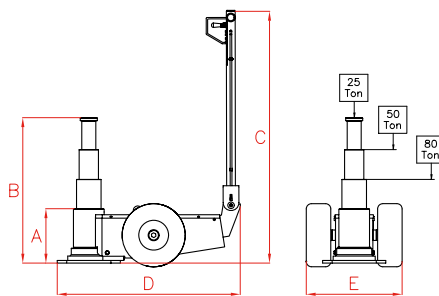

### HL06022

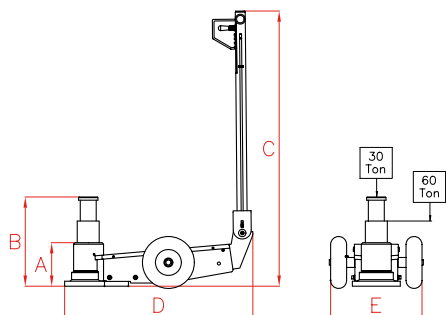

### HL10044

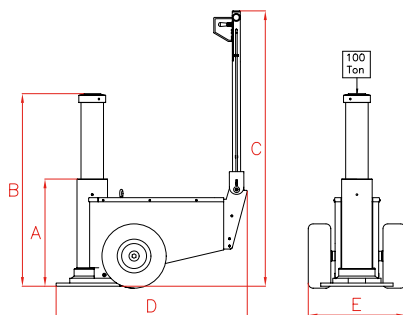

### HL15055

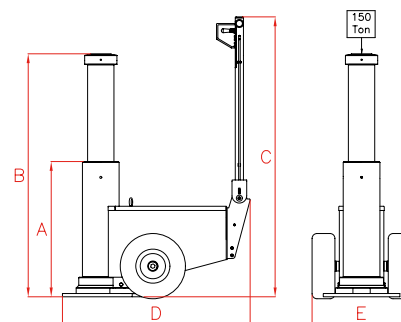

Capacity	Stroke	Model	A	B	C	D	E	Weight
Tn	mm	LARZEP	mm	mm	mm	mm	mm	kg
30/60	110+117	<b>HL06022</b>	220	447	1.385	940	460	93
50/80	196+222	<b>HL08042</b>	420	838	1.440	1.039	540	161
25/50/80	167+171+180	<b>HL08052</b>	341	859	1.440	1.040	540	143
100	445	<b>HL10044</b>	725	1.170	1.720	1.180	610	290
150	554	<b>HL15055</b>	900	1.454	1.720	1.250	620	385



Extensions



Extension Holder

## ACCESORIES (Optional)

Model	Extension Holder		Extensions							
	Right	Left	10 mm	70 mm	120 mm	150 mm	200 mm	250 mm	300 mm	
<b>HL06022</b>	-	-	HLE06001	HLE06007	HLE06012	-	-	-	-	
<b>HL08042</b>	HLT080R	HLT080L	-	-	-	HLE08015	-	HLE08025	HLE08030	
<b>HL08052</b>	HLT080R	HLT080L	-	-	-	HLE08015	-	HLE08025	HLE08030	
<b>HL10044</b>	HLT150R	HLT150L	-	-	-	-	HLE15020	HLE15025	HLE15030	
<b>HL15055</b>	HLT150R	HLT150L	-	-	-	-	HLE15020	HLE15025	HLE15030	

Model	Safety Blocks				
	50mm M/F	100mm M/F	100mm F/F	Holder	Kit*
<b>HL06022</b>	-	-	-	-	-
<b>HL08042</b>	HLB05017M	HLB10017M	HLB10017F	HLC100	HLS100
<b>HL08052</b>	HLB05017M	HLB10017M	HLB10017F	HLC100	HLS100
<b>HL10044</b>	HLB05017M	HLB10017M	HLB10017F	HLC100	HLS100
<b>HL15055</b>	HLB05021M	HLB10021M	HLB10021F	HLC150	HLS150

Model	Remote Pendant	Manual Pump
<b>All models</b>	HLR	HLH



HLR



HLH

\*Safety blocks kit **HLS100**: HLB05017M + 3xHLB10017M + HLB10017F + HLC100

\*Safety blocks kit **HLS150**: HLB05021M + 4xHLB10021M + HLB10021F + HLC150

**HYDRAULIC PIPE BENDERS**



**LARZEP advantages**

- Suitable for carrying out bending operations with plumbing pipes.
- Pipe bending capacities of up to 2", 3" and 6" NB.
- Models: with hand pump (VA, VB), with electric pump (VC), or with air/hydraulic pump (VZ).
- Equipped with a safety relief valve to prevent overpressure.
- Delivered in sturdy wooden storage boxes.
- VB1227 model equipped with a tripod stand.



Hand Pumps, W.

Page. 80



Air Hydraulic Pump Z12107.

Page. 82



Manual Powerpacks, HAM.

Page. 84



VC7532

## HYDRAULIC PIPE BENDERS

# VA - VB VC - VZ

3/8 - 6 inch

700 bar

AUTOMOTIVE

## HYDRAULIC PIPE BENDERS

Pipe	Model	Pump type				Cylinder	Stroke	Tripod stand	Weight
		Bottle Jack	Hand	Electric	Air				
"	LARZEP	Bottle Jack	Hand	Electric	Air	LARZEP	mm	*	kg
3/8 - 2"	VA1227	AV1227	-	-	-	AV1227	285	-	61
	VB1227	AV1227	-	-	-	AV1227	285	*	70
	VA1225	-	W10707	-	-	SM01025	257	-	55
	VZ1225	-	-	-	Z12107	SM01025	257	-	57
	VC1225	-	-	HAM1211	-	SM01025	257	-	90
1/2 - 3"	VA1536	-	W21207	-	-	SM01535	355	-	75
	VZ1536	-	-	-	Z12107	SM01535	355	-	77
	VC1536	-	-	HAM1211	-	SM01535	355	-	120
1/2 - 6"	VC7532	-	-	HAM7244	-	D07532	320	-	465

## BENDING SHOES

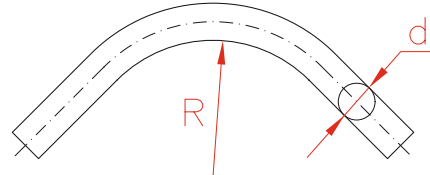

### VA1227, VB1227, VA1225, VZ1225, VC1225

Nominal Bore	3/8"	1/2"	3/4"	1"	1 1/4"	1 1/2"	2"
External Diameter d (mm)	17,2	21,3	26,9	33,7	42,4	48,3	60,3
Maximun Wall Thickness (mm)	2,9	3,2	3,2	4,0	4,0	4,0	4,5
Bend Radius R (mm)	60	85	120	140	175	210	260

### VA1536, VZ1536, VC1536

Nominal Bore	1/2"	3/4"	1"	1 1/4"	1 1/2"	2"	2 1/2"	3"
External Diameter d (mm)	21,3	26,9	33,7	42,4	48,3	60,3	76,1	88,9
Maximun Wall Thickness (mm)	3,2	3,2	4,0	4,0	4,0	4,5	4,5	4,8
Bend Radius R (mm)	40	60	80	100	115	165	245	290

### VC7532

Nominal Bore	1/2"	3/4"	1"	1 1/4"	1 1/2"	2"	2 1/2"	3"	4"	5"	6"
External Diameter d (mm)	21,3	26,9	33,7	42,4	48,3	60,3	76,1	88,9	114,0	141,0	168,0
Maximun Wall Thickness (mm)	3,2	3,2	4,0	4,0	4,0	4,5	4,5	4,8	5,4	5,4	5,4
Bend Radius R (mm)	40	60	80	100	115	165	245	290	550	650	750

**HYDRAULIC PRESSES**



**LARZEP advantages**

- Extremely sturdy frames, made from welded steel profiles, available as bench mount (EC series) and floor mounted H-Frame models.
- Models are available powered by hand pump, air/hydraulic pump or electric/hydraulic pump. CE versions are fitted with remote motor control.
- Table height is adjustable on floor mounted models, manually on 30 Tn, winch on 60 Tn and 120 Tn models and hydraulically from the main ram on 250 Tn models.
- Vee blocks and a pressure gauge reading in tons are supplied as standard on all models.
- The hydraulic cylinder on the ECM and ECZ bench presses can be easily removed and used in other applications.
- On the 30 Tn EM and EZ presses, the hydraulic cylinder is equipped with a screw extension designed to minimise the pumping action required.
- The EM models incorporate a two-speed hand pump for quick approach of the piston to the work piece.



Larzep designs and manufactures special presses upon request.



HYDRAULIC PRESSES

EC - EE  
EM - EZ

10-250 Tn.

700 bar

AUTOMOTIVE

The hydraulic cylinder can be easily removed and used in other applications.



On the 30 Tn EM and EZ presses, the hydraulic cylinder is equipped with a screw extension designed to minimise the pumping action required.



Vee blocks and pressure gauge reading in tons are supplied as standard on all models.



10 Tn and 20 Tn EC series.  
Bench mount presses.



Air Hydraulic Pump  
Z12107.

Page. 82



Hand Pumps, W.

Page. 80



Capacity	Frame		E	H max.	Stroke	Model	Pump Type			
Tn	Bench Mount	Floor Mount	mm	mm	mm	LARZEP	Hand	Electric	Air	Model
10	*	-	350	352	130	ECM01113	*	-	-	W10707
	*	-	350	352	130	ECZ01113	-	-	*	Z12107
	*	-	350	352	130	ECE01113	-	*	-	HAM7224
	*	-	350	352	130	ECE01113-CE	-	*	-	HAM7224B
20	*	-	500	330	130	ECM02013	*	-	-	W10707
	*	-	500	330	130	ECZ02013	-	-	*	Z12107
	*	-	500	330	130	ECE02013	-	*	-	HAM7224
	*	-	500	330	130	ECE02013-CE	-	*	-	HAM7224B
30	-	*	500	930	95	EM03012	*	-	-	W00807
	-	*	500	930	95	EZ03012	-	-	*	Z12107
	-	*	500	930	160	EE03116	-	*	-	HAM7244
	-	*	500	930	160	EE03116-CE	-	*	-	HAM7244B
60	-	*	860	935	180	EM06018	*	-	-	W23007
	-	*	860	935	180	EZ06018	-	-	*	Z12107
	-	*	860	935	180	EE06018	-	*	-	HAM7244
	-	*	860	935	180	EE06018-CE	-	*	-	HAM7244B
120	-	*	880	910	180	EZ12018	-	-	*	Z24007
	-	*	880	910	180	EE12018	-	*	-	HAM7344
	-	*	880	910	180	EE12018-CE	-	*	-	HAM7344B
250	-	*	1.080	1.000	300	EE25030-CE	-	*	-	HAM8544B

Model	A	B	C	D	E	F	H min	H max.	I	K	M	N	O
LARZEP	mm	mm	mm	mm	mm	mm	mm	mm	mm	mm	mm	mm	mm
ECM01113	720	440	220	80	350	170	-	352	80	-	400	198	12
ECZ01113	720	440	220	80	350	170	-	352	80	-	400	198	12
ECE01113	720	440	220	80	350	170	-	352	80	-	400	198	12
ECE01113-CE	720	440	220	80	350	170	-	352	80	-	400	198	12
ECM02013	785	610	325	120	500	240	-	330	140	-	570	285	12
ECZ02013	785	610	325	120	500	240	-	330	140	-	570	285	12
ECE02013	785	610	325	120	500	240	-	330	140	-	570	285	12
ECE02013-CE	785	610	325	120	500	240	-	330	140	-	570	285	12
EM03012	1.780	698	650	125	500	245	30	930	140	120	280	150	27
EZ03012	1.780	698	650	125	500	245	30	930	140	-	280	150	27
EE03116	1.780	698	650	125	500	245	30	930	140	275	280	150	27
EE03116-CE	1.780	698	650	125	500	245	30	930	140	275	280	150	27
EM06018	1.960	1.150	800	205	860	385	110	935	260	150	237	165	41
EZ06018	1.960	1.150	800	205	860	385	110	935	260	-	237	165	41
EE06018	1.960	1.150	800	205	860	385	110	935	260	275	237	165	41
EE06018-CE	1.960	1.150	800	205	860	385	110	935	260	275	237	165	41
EZ12018	2.010	1.240	800	308	880	510	80	910	300	-	277	165	51
EE12018	2.010	1.240	800	308	880	510	80	910	300	275	277	165	51
EE12018-CE	2.010	1.240	800	308	880	510	80	910	300	275	277	165	51
EE25030-CE	2.256	1.640	1.000	318	1.080	486	100	1.000	487	-	130	225	80

	Cylinder type				Oil Cap. cm <sup>3</sup>	Advance speed*		Weight kg	Model
	S/A	D/A	Screw	Model		Fast	Slow		
*	-	-	-	KC01113	214	-	1,7	41	<b>ECM01113</b>
*	-	-	-	KC01113	214	-	1,8	42	<b>ECZ01113</b>
*	-	-	-	KC01113	214	31,0	5,8	75	<b>ECE01113</b>
*	-	-	-	KC01113	214	31,0	5,8	80	<b>ECE01113-CE</b>
*	-	-	-	KC02013	431	5,5	0,9	85	<b>ECM02013</b>
*	-	-	-	KC02013	431	-	1,2	90	<b>ECZ02013</b>
*	-	-	-	KC02013	431	21,0	3,9	150	<b>ECE02013</b>
*	-	-	-	KC02013	431	21,0	3,9	155	<b>ECE02013-CE</b>
*	-	65	-	SM03012	419	2,9	0,4	120	<b>EM03012</b>
*	-	65	-	SM03012	419	-	0,6	121	<b>EZ03012</b>
-	*	-	-	D03016	707	11,3	2,1	135	<b>EE03116</b>
-	*	-	-	D03016	707	11,3	2,1	140	<b>EE03116-CE</b>
*	-	-	-	SM06018	1.558	1,5	0,2	455	<b>EM06018</b>
*	-	-	-	SM06018	1.558	-	0,4	456	<b>EZ06018</b>
-	*	-	-	D06018	1.558	5,7	1,0	480	<b>EE06018</b>
-	*	-	-	D06018	1.558	5,7	1,0	485	<b>EE06018-CE</b>
-	*	-	-	D12018	3.180	-	0,2	720	<b>EZ12018</b>
-	*	-	-	D12018	3.180	2,8	0,5	750	<b>EE12018</b>
-	*	-	-	D12018	3.180	2,8	0,5	755	<b>EE12018-CE</b>
-	*	-	-	D25030	10.390	4,3	1,0	2.100	<b>EE25030-CE</b>

\* Hand Pump (mm/stroke)

\* Electric Pump (mm/sec.)

\* Air Pump (mm/sec.)

## 10 and 20 Tn PRESSES

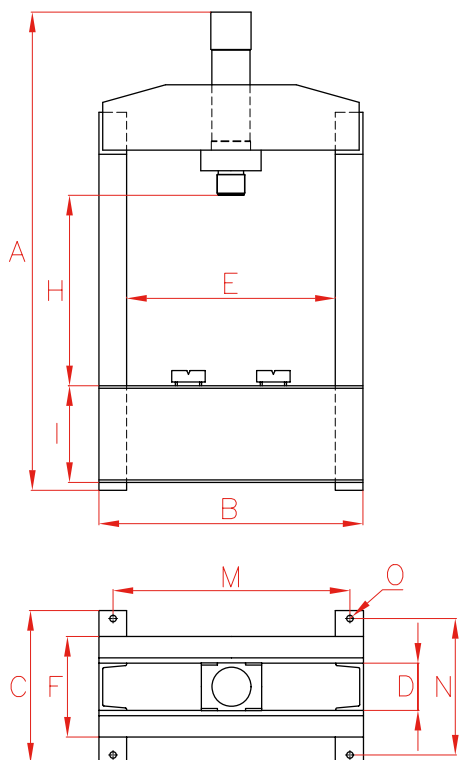

## 30, 60, 120 and 250 Tn PRESSES

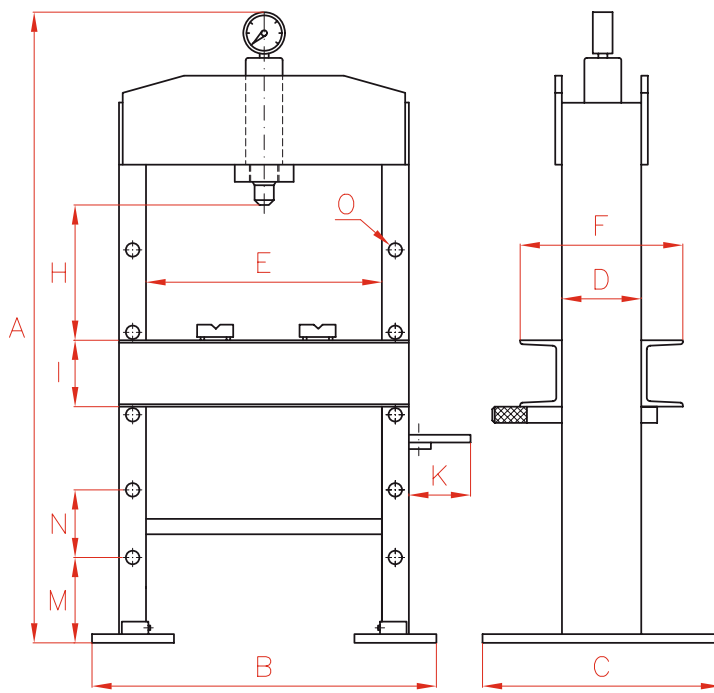

**MAINTENANCE SETS**



**LARZEP advantages**

- Made of a series of attachments that combined with the pump, cylinder and hose, enable configuration of specific tools designed for various operations such as pushing, separating, joining, lifting, compressing, stretching and fixing.
- 5, 10 and 20 Tn models available.
- Supplied in a storage/transport case.

**KC**

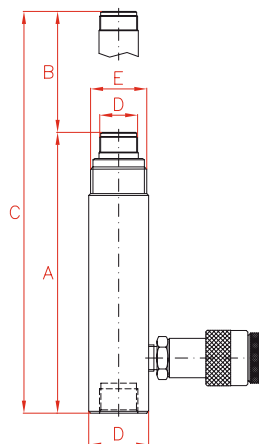

**T**

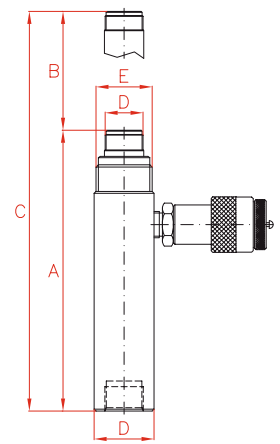

Capacity	Model	A	B	C	D	E
Tn	LARZEP	mm	mm	mm	BSP	UN
5	<b>KC00511</b>	237	115	352	3/4"-14 BSP	1 1/2"-16 UN
10	<b>KC01113</b>	274	133	409	1 1/4"-11 BSP	2 1/4"-14 UNS
20	<b>KC02013</b>	286	130	416	1 3/4"-11 BSP	3 5/16"-11 UN
5	<b>T00514/5*</b>	306	140	446	3/4"-14 BSP	2 1/4"-14 UNS
5	<b>T00514/10*</b>	306	140	446	1 1/4"-11 BSP	2 1/4"-14 UNS
10	<b>T01015*</b>	308	140	448	1 3/4"-11 BSP	3 5/16"-11 UN

\* Optional

The cylinder provides the indicated nominal force, but as some attachments can induce cylinder side loading, the unit can only be used at 50% of its capacity, at a **MAXIMUM WORKING PRESSURE** of 350 bar.



		Capacity (Tn)		10		20	
No.	Model	5	5	10	10	20	20
		CA0510	CA0513	CA1110	CA1113	CA2010	CA2013
1	Case	CA051301	CA051301	CA101301	CA101301	CA101301	CA101301
2	Pump	W00307	W00307	W10707	W10707	W10707	W10707
3	Hose	AP2015	AP2015	AP2015	AP2015	AP2015	AP2015
4	Coupling	AZ3220	AZ3220	AZ3220	AZ3220	AZ3220	AZ3220
5	Cylinder	KC00511	KC00511	KC01113	KC01113	KC02013	KC02013
7	Tube M	CA051307	CA051307	CA101307	CA101307	-	-
8	Tube L	CA051308	CA051308	CA101308	CA101308	CA201308	CA201308
9	Tube X	CA051309	CA051309	CA101309	CA101309	CA201309	CA201309
10	Tube XL	CA051310	CA051310	CA101310	CA101310	CA201310	CA201310
11	Collar toe ram	CA051311	CA051311	CA101311	CA101311	CA201311	CA201311
12	Collar toe plunger	CA051312	CA051312	CA101312	CA101312	-	-
13	Pipe coupling (3)	CA051313	CA051313	CA101313	CA101313	CA201313	CA201313
14	Male connector	CA051314	CA051314	CA101314	CA101314	CA201314	CA201314
15	Head	CA051315	CA051315	CA101315	CA101315	CA201315(2)	CA201315(2)
16	Rubber head (2)	CA051316	CA051316	CA101316	CA101316	-	-
17	Base	CA051317	CA051317	CA101317	CA101317	-	-
18	“V”	CA051318	CA051318	CA101318	CA101318	-	-
19	Wedge head	CA051319	CA051319	CA101319	CA101319	-	-
20	Slip-lock extension	CA051320	CA051320	CA101320	CA101320	-	-
21	Locking pin (2)	CA051321	CA051321	CA101321	CA101321	-	-
22	Collar clamp head	CA051322	CA051322	CA101322	CA101322	-	-
23	Lock-on clamp toe	CA051323	CA051323	CA101323	CA101323	-	-
24	Spread cylinder	-	CY0109	-	CY0109	-	CY00822
25	Chain	-	CA051325	-	CA101325	-	CA201325
26	Single chain plate	-	CA051326	-	CA101326	-	CA201326
27	Double chain plate	-	CA051327	-	CA101327	-	-
28	Base (2)	-	-	-	-	CA201328	CA201328
29	Pulling cylinder*	T00514/5	T00514/5	T00514/10	T00514/10	T01015	T01015
30	Pressure gauge	AV10006	AV10006	AV10006	AV10006	AV10006	AV10006
31	Gauge adaptor	AZ1502	AZ1502	AZ1502	AZ1502	AZ1502	AZ1502

\* Optional

**7-8-9-10 TUBE**

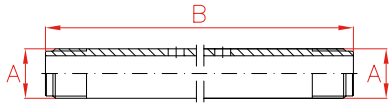

Reference	A	B
CA051307	3/4"-14 BSP	125
CA051308	3/4"-14 BSP	250
CA051309	3/4"-14 BSP	450
CA051310	3/4"-14 BSP	575
CA101307	1 1/4"-11 BSP	130
CA101308	1 1/4"-11 BSP	250
CA101309	1 1/4"-11 BSP	450
CA101310	1 1/4"-11 BSP	700
CA201308	1 3/4"-11 BSP	220
CA201309	1 3/4"-11 BSP	480
CA201310	1 3/4"-11 BSP	700

**12 COLLAR TOE PLUNGER**

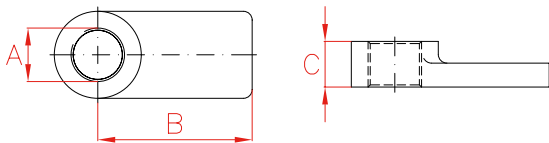

Reference	A	B	C	D
CA051312	3/4"-14 BSP	71	22	42
CA101312	1 1/4"-11 BSP	80	32	60

**14 MALE CONNECTOR**

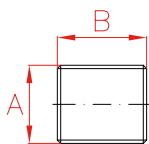

Reference	A	B
CA051314	3/4"-14 BSP	36
CA101314	1 1/4"-11 BSP	52
CA201314	1 3/4"-11 BSP	54

**16 RUBBER HEAD**

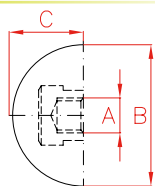

Reference	A	B	C
CA051316	3/4"-14 BSP	80	50
CA101316	1 1/4"-11 BSP	90	55

**11 COLLAR TOE RAM**

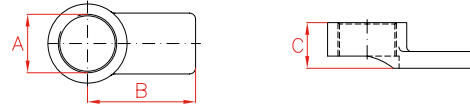

Reference	A	B	C	D
CA051311	1 1/2"-16 UN	71	31	42
CA101311	2 1/4"-14 UNS	79	38	61
CA201311	3 5/16"-12 UN	110	41	73

**13 PIPE COUPLING**

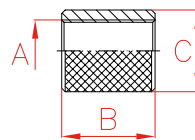

Reference	A	B	C
CA051313	3/4"-14 BSP	40	35,0
CA101313	1 1/4"-11 BSP	49	55,5
CA201313	1 3/4"-11 BSP	70	52,0

**15 HEAD**

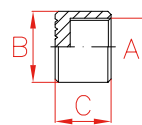

Reference	A	B	C
CA051315	3/4"-14 BSP	33	26
CA101315	1 1/4"-11 BSP	51	34
CA201315	1 3/4"-11 BSP	69	48

**17 BASE**

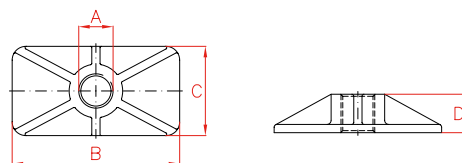

Reference	A	B	C	D
CA051317	3/4"-14 BSP	123	65	30
CA101317	1 1/4"-11 BSP	164	102	31

18 "V"

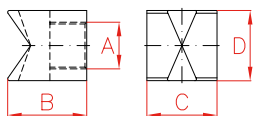

Reference	A	B	C	D
CA051318	3/4"-14 BSP	46	40	38
CA101318	1 1/4"-11 BSP	60	69	56

20 SLIP-LOCK EXTENSION

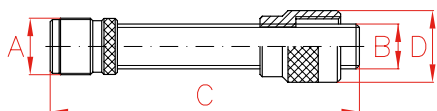

Reference	A	B	C	D
CA051320	3/4"-14 BSP	M20x2,5	138	32
CA101320	1 1/4"-11 BSP	Tr30 - 5	151	54

22 COLLAR CLAMP HEAD

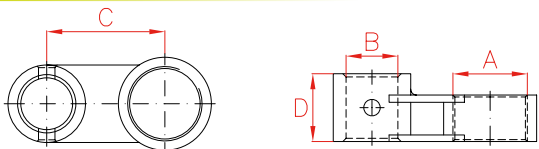

Reference	A	B	C	D
CA051322	1 1/2"-16 UN	26,7	61	36
CA101322	2 1/4"-14 UNS	42,2	68	41

25 CHAIN

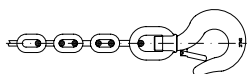

Reference	Length
CA051325	1 metre
CA101325	1 metre
CA201325	1 metre

27 DOUBLE CHAIN PLATE

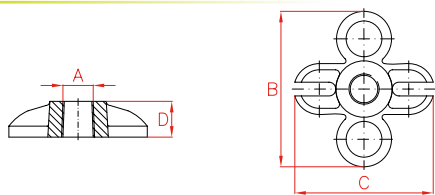

Reference	A	B	C	D
CA051327	3/4"-14 BSP	113	101	27
CA101327	1 1/4"-11 BSP	145	140	31

19 WEDGE HEAD

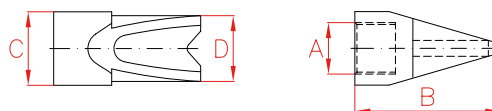

Reference	A	B	C	D
CA051319	3/4"-14 BSP	77	40	34
CA101319	1 1/4"-11 BSP	99	55	43

21 LOCKING PIN

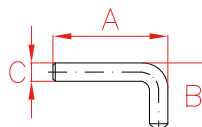

Reference	A	B	C
CA051321	50	27	8
CA101321	76	42	12

23 LOCK-ON CLAMP TOE

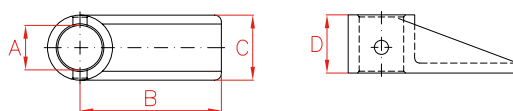

Reference	A	B	C	D
CA051323	26,7	87	39	36
CA101323	42,7	100	62	41

26 SINGLE CHAIN PLATE

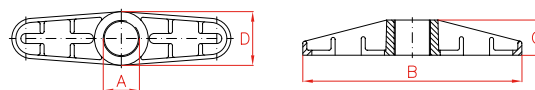

Reference	A	B	C	D
CA051326	1 1/2"-16 UN	218	35	53
CA101326	2 1/4"-14 UNS	268	42	81
CA201326	3 5/16"-12 UN	385	60	109

28 BASE

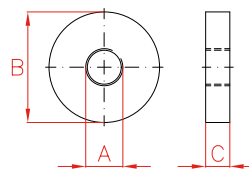

Reference	A	B	C
CA201328	1 3/4"-11 BSP	128	28

**LIGHTWEIGHT RESCUE UNIT**



**LARZEP advantages**

- Lightweight, self contained rescue unit. No need for external power. Can be handled by just one person.
- Consists of a foot operated pump, cutting shears, two spread cylinders and a hydraulic cylinder with extensions and support heads.
- For separating, cutting and pushing, the three basic operations in a rescue.
- The tools are connected individually to the pump via a hydraulic hose, equipped with all the necessary quick-connect fittings.
- The size of the tool enables the user to operate effectively even in hard-to-reach places.
- Two speed pump, for fast approach and automatic changeover when load is contacted.
- Pumping is carried out via the foot pedal, leaving hands free to hold the tool.
- Internal spring provides rapid cylinder retraction.
- The unit is supplied with a storage/carry case equipped with wheels and a retracting handle.

LIGHTWEIGHT RESCUE UNIT	CS45
Pump	WP01205
Cutter	CD045
Spread cylinder	CY0109-CS
Spread cylinder	CY00822-CS
Cylinder	SM00427
Total weight	45 kg

PUMP	Ref. WP01205
Usable oil:	1.200 cm <sup>3</sup>
Oil displacement per stroke	
1st stage (20 bar):	13 cm <sup>3</sup>
2nd stage (550 bar):	2 cm <sup>3</sup>
Weight:	10,6 kg

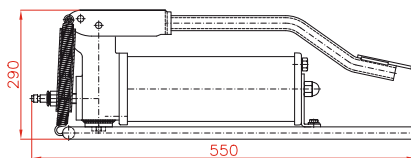

## LIGHTWEIGHT RESCUE UNIT

# CS

## 0,7-7 Tn.

## 550 bar

AUTOMOTIVE

CUTTER	Ref. CD045
Capacity:	7 Tn
Maximum pressure:	550 bar
Clearance:	60 mm
Effective area:	12,5 cm <sup>2</sup>
Oil capacity:	43,9 cm <sup>3</sup>
Weight:	4,3 kg

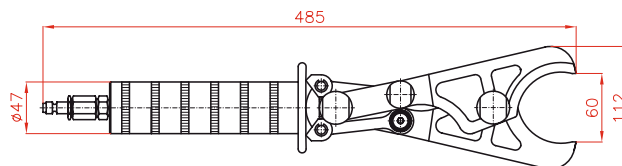

SPREAD CYLINDER	Ref. CY0109-CS
Capacity:	0,7 Tn
Maximum pressure:	700 bar
Closed tip clearance:	15 mm
Open tip clearance:	90 mm
Effective area:	6,6 cm <sup>2</sup>
Oil capacity:	10 cm <sup>3</sup>
Weight:	1,9 kg

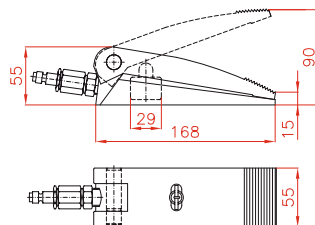

SPREAD CYLINDER	Ref. CY00822-CS
Capacity:	0,8 Tn
Maximum pressure:	550 bar
Closed tip clearance:	31 mm
Open tip clearance:	220 mm
Effective area:	14,5 cm <sup>2</sup>
Oil capacity:	76,8 cm <sup>3</sup>
Weight:	6,2 kg

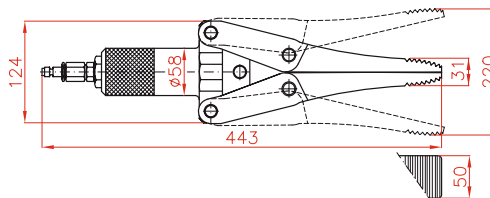

CYLINDER	Ref. SM00427
Capacity:	3,8 Tn
Maximum pressure:	700 bar
Collapsed height:	467 mm
Stroke:	275 mm
Effective area:	7,06 cm <sup>2</sup>
Oil capacity:	194,3 cm <sup>3</sup>
Weight:	3,6 kg
Extension tubes:	250/400 mm

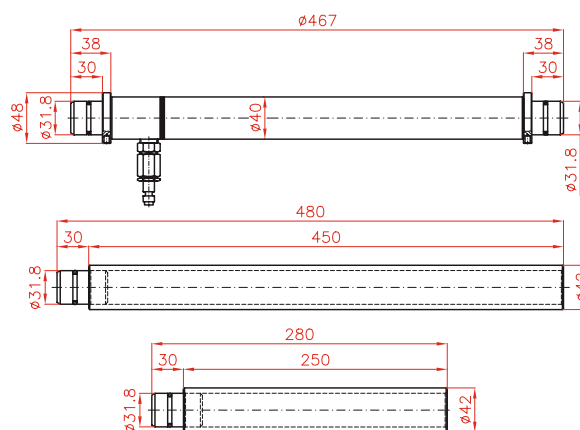

ACCESORIES
"V" saddle
"X" saddle
Base
Handspike
Hose (3 m)

### BASE

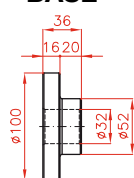

### "V" SADDLE

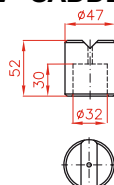

### "X" SADDLE

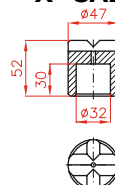

### HOSE

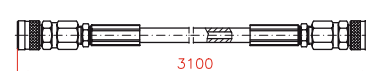

### HANDSPIKE

