

• RESERVOIR CAPACITY	0,7 - 1,2 l
• OIL DELIVERY PER STROKE IN HP	1,1 - 2,7 cm ³
• MAX PRESSURE	700 bar

PNP

HAND PUMPS WITH TANK IN PLASTIC / 700 bar

FEATURES

The main feature of the **PNP** pump is its extreme lightness given that the body of the pump is produced from extruded aluminum and the oil tank from glass reinforced nylon.

The practical pedal locking hook allows the use of the **lever as a handle during transport** by holding it in the correct manner it will balance the pump even if equipped with ancillaries.

All **PNP** pumps can work vertically with the pumping head pointing downwards with a smaller oil volume than their nominal capacity.

All 700 bar models have:

- Externally adjustable relief valve.
- 1/4 " NPT side port for the direct fitting of the gauge.
- Fitting holes.
- Tank from 0,7 - 1,2 l.
- The PNP240 model pump is equipped with a 4 way valve with 3 positions for the usage of the pump with double acting cylinders.



HYDRAULIC PUMPS

PNP1###

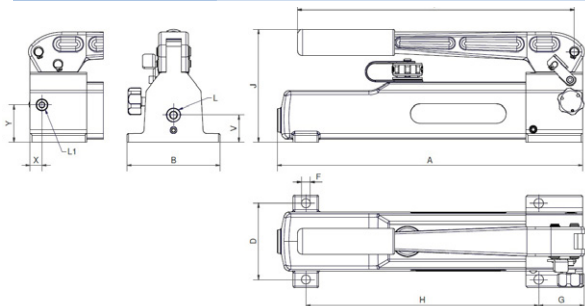

PNP240

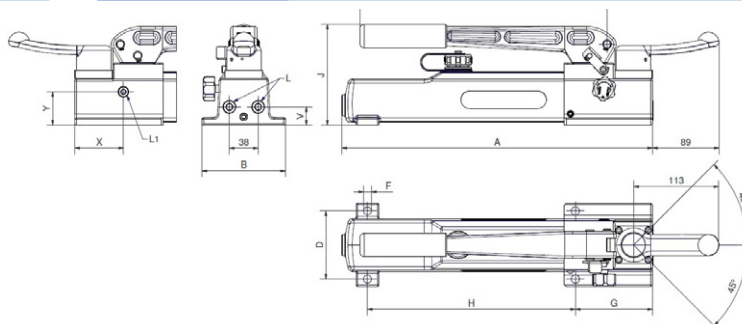

SELECTION CHART

PRESSURE 1° STAGE bar	PRESSURE 2° STAGE bar	OIL DELIVERY PER STROKE 1° STAGE cm ³	OIL DELIVERY PER STROKE 2ND STAGE cm ³	HANDLE EFFORT N	FOR USE WITH CYLINDERS	RESERVOIR CAPACITY litres	USABLE OIL VOLUME litres	MODEL	DIMENSIONS MM											WEIGHT kg		
									A	B	D	G	H	F	J	L	L1	P	V		X	Y
-	700	-	1.7	426	Single acting	0.7	0.5	PNP130	362	110	90	52	275	11	135	3/8" NPT	1/4" NPT	330	32	14	44	3
			2.7	363		1.2	1	PNP131	551	110	90	52	460	11	135			554	32	14	44	4
			14.7	1.1		455	0.7	0.5	PNP140	362	110	90	52	275	11	135	330	32	14	44	3	
			13.7	2.2		380	1.2	1	PNP141	551	110	90	52	460	11	135	544	32	14	44	4	
20		14.7	1.1	455	Double acting	0.7	0.5	PNP240	414	110	90	104	275	11	135	3/8" NPT	1/4" NPT	330	24	66	44	3.5

MODEL CODING

PNP	13	#	G
Series	Pump type	Reservoir capacity in litres	Gauge
		Max pressure 700 bar	