

UML

LIGHTWEIGHT ALUMINIUM JACKS

FEATURES

UML are self contained compact lifting units with the capacity to lift up to 100 tonnes. They are portable, efficient and reliable.

They are available in three different versions:

- **Standard** with plain ram for vertical lifting or horizontal pushing on the front face.
- **Lock ring** with screwed ram and locking collar, an ideal solution to support the load mechanically for long periods.
- **With claw** for conventional load lifting or lifting from very low heights on the claw.

These models have extended bases for maximum stability.

All models are provided with:

- A built-in safety valve to prevent overload.
- A release valve controller by an operating lever to lift and lower the jack.
- Built-in carry handle for models over 15 tonnes.

OPERATIONAL AREAS

Thanks to their light weight and easy handling these jacks are particularly versatile and suitable for many applications as: industrial, civil, ship repair, and railway industries.



For aeronautical use, to lift aeroplanes, it is necessary to purchase the specific custom saddle for each aircraft.



In the claw version the load to be lifted must not exceed the value indicated on the claw and in the chart.



Follow EUROPRESS safety instructions, check useful pages 176.

UML

LIGHTWEIGHT ALUMINIUM JACKS

• FORCE	6,5 - 100 t
• STROKE	75 - 305 mm

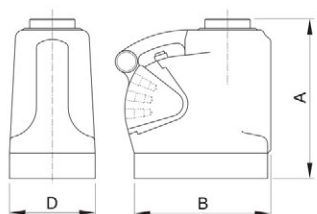

UML#N

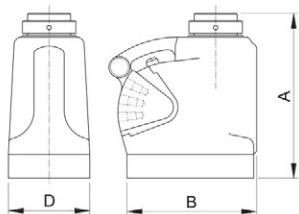

UML#G

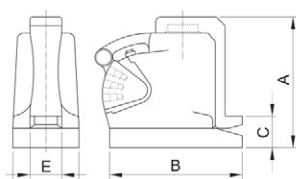

UML#C



SELECTION CHART ALUMINIUM JACKS

Type	Pushing force t	Maximum load on the claw t	Stroke mm	MODEL	Dimensions mm					Weight kg
					A	B	C	D	E	
Standard	6,5	-	75	UML6N75	140	158		76		3,6
	10	-	115	UML10N115	182	171				6,3
	15	-	152	UML15N152	230	197		92		10
	20	-	152	UML20N152	263	178		121		11
			305	UML20N305	438	246			17	
	30	-	152	UML30N152	263	197		140		15,4
			305	UML30N305	451	273			23,4	
	60	-	152	UML60N152	293	251		190		27,5
305			UML60N305	500	339		43,7			
100	-	152	UML100N152	313	310		241		49	
With safety lock ring	20	-	152	UML20G152	289	178		121		10,9
			305	UML20G305	464	246			16,7	
	30	-	152	UML30G152	292	197		140		15,4
			305	UML30G305	479	273			23,4	
	60	-	152	UML60G152	330	251		190		27,5
			305	UML60G305	536	339			43,7	
100	-	152	UML100G152	357	310		241		53	
With claw	20	8	152	UML20C152	276	214	67	121	60	14,5
			305	UML30C305	452					22,2
	30	12	152	UML30N152	281	235	73	140	76	20,3
			305	UML30C305	470					31
	60	24	152	UML60C152	327	286	73	190	108	43,1
			305	UML60C305	533					64,9