

# CA2014 MAINTENANCE SET

## Features

- Made of a series of attachments that combined with the pump, cylinder and hose, enable configuration of specific tools designed for various operations such as pushing, separating, joining, lifting, compressing, stretching and fixing.
- 10T & 20T model available.
- Supplied in a storage/transport case.



**Capacity: 20 Tn**  
(10tn with attachments)

No.	Description	Quantity
CA2014		
1	Pump	1
2	Hose	1
3	Male Quick Coupler	1
4	Cylinder KC02014	1
5	Tube L 255 mm	1
6	Tube X 460 mm	1
7	Tube XL 700 mm	1
8	Pipe Coupling	2
9	Male Connector	1
10	Saddle	1
11	Base	2
12	Toe	1
	Case	1
	Weight (kg)	45

Available Options	Model
Pressure Gauge	G106
Gauge Adaptor	<b>RP52</b>

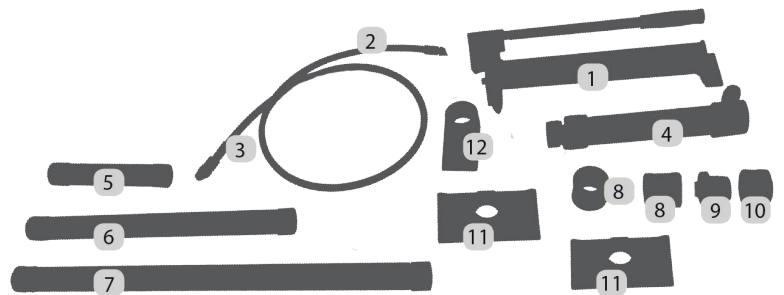

## WARNING

The cylinder provides the indicated nominal force, but as some attachments can induce cylinder side loading, the unit can only be used at 50% of its capacity, at a **MAXIMUM WORKING PRESSURE OF 350 BAR.**